

Confidential-MOBILE

Secure Mobile Phone

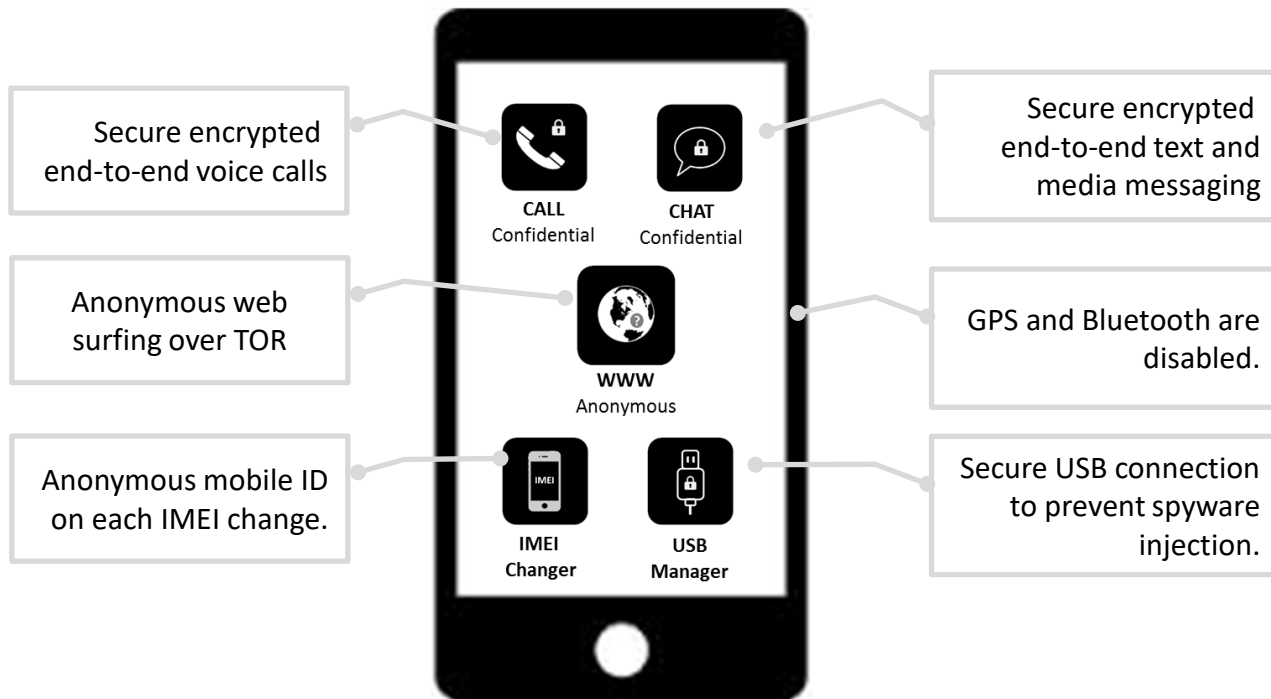

Confidential-MOBILE | Screen



Confidential-MOBILE | Secure

- Secure mobile phone for making secure phone calls and chat messaging.
- Confidential-CALL app: end-to-end secure encrypted calls.
- Confidential-CHAT app: end-to-end secure encrypted text and media messaging.
- IMEI-Changer app: change IMEI instantly for network anonymity.
- Disable device GPS not being followed and detected.
- Disable Bluetooth and USB to block any spyware injection.
- Disable any new app installation to block and spyware injection.
- Allow Internet connection for only the Confidential-CALL/CHAT apps for blocking any spyware connections.
- Changes Caller-IDs for outgoing calls to any phone number.



Confidential-CALL *app*

End-to-End Secure Encrypted Call

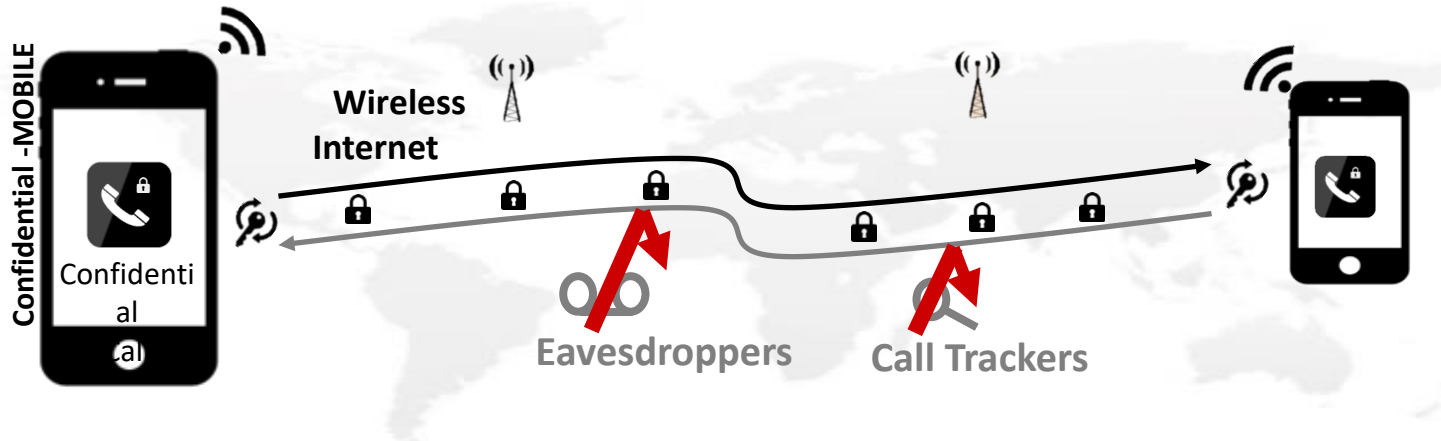

- 🔒 An advanced secure SIP/VoIP call application connecting over any WiFi/3G/4G wireless connection.
- 🔒 The Confidential-CALL app encrypts all call session info, specifically the caller and called IDs to prevent call tracking of the caller/called personal IDs.
- 🔒 The Confidential-CALL app dynamically generating a new fresh unbreakable encryption key per call initiation, which is flushed out at the end of each call.
- 🔒 The Confidential-Call app encrypts peer-to-peer all conversation voice stream to prevent call eavesdropping.
- 🔒 The Confidential-CALL app utilizes high quality 8K codec for call quality optimization over narrow wireless connections.

Confidential-CALL app | Mobile UI

Secure Encrypted Call Session

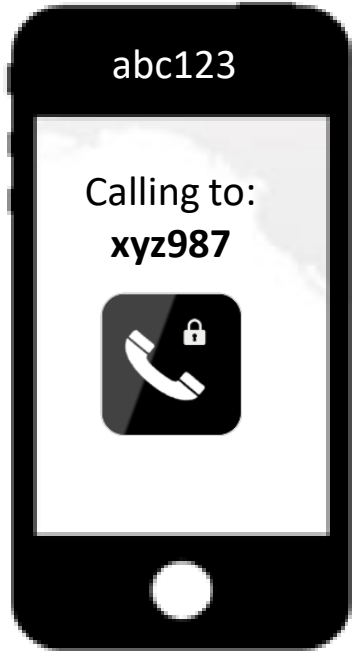

1

- > Username is defined as **arbitrary** alphanumeric string.
- > SIP Call session info is encrypted over **SSL/TLS** between device and network registration node.

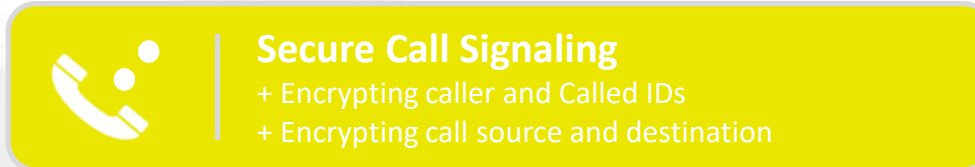

2

- > **Fresh encryption key** is negotiated peer-to-peer per call initiation without any network element intervention.
- > On call answer, **Diffie-Helman key agreement algorithm** is used over the peer-to-peer RTP stream.



3

- > The actual call SRTP is encrypted with '**Twofish**' 256 bit.
- > An identical **SAS** (Short-Auth'-String) is displayed on both devices to eliminate **MITM** (Man-In-The-Middle) attack.



Confidential-CALL *app*

Secure encrypted end-to-end call

1. Connect

1.1 Internet WiFi or SIM Data 3G/4G

1.2 Connected.
Ready.

1.3 Add secure contacts #
(username)

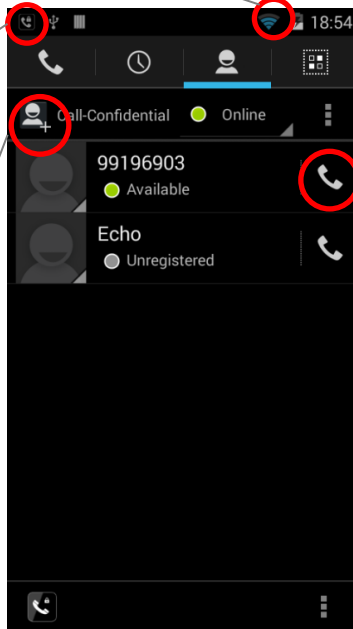

2. Dial

2.1 Dial contact (**Available**)

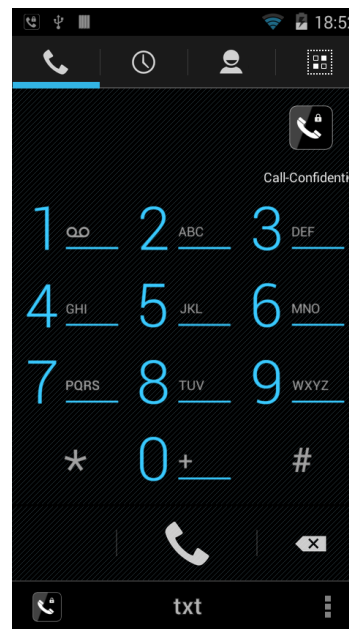

2.2 Dial-Pad

Dial any regular phone #
Example UK# (exclude + prefix):
44 20 1234 5678

3. Talk Securely

3.1 Verify unique encryption code

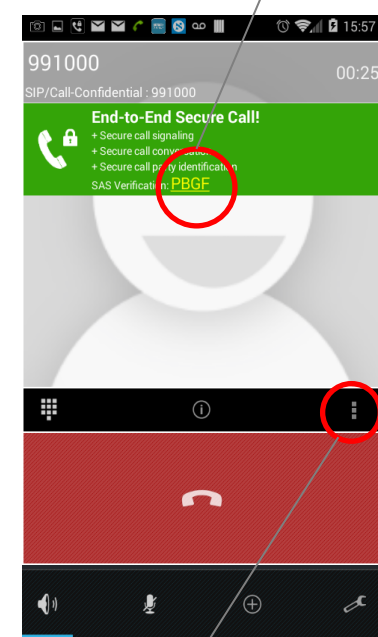

3.2 Start/Stop Call record.

Find file records in app





Confidential-CHAT app

Secure encrypted end-to-end call

1. Connect

1.1 Internet WiFi or SIM Data 3G/4G

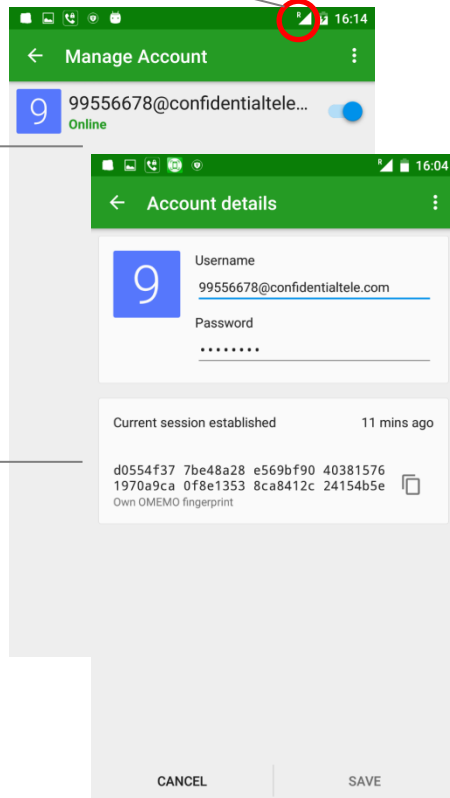

1.2
Online
Ready.

1.3
Encryption
Fingerprint

2. Invite

2.1 Invite new contact

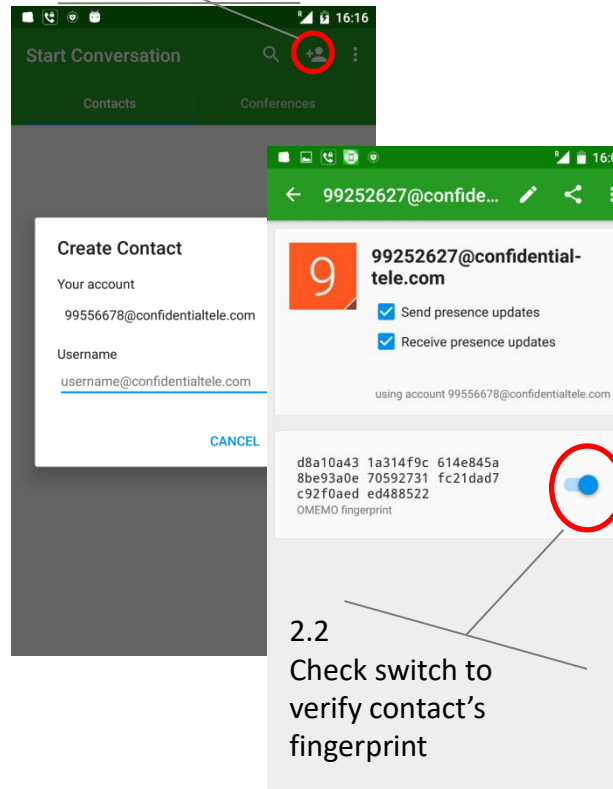

2.2
Check switch to
verify contact's
fingerprint

3. Chat Securely

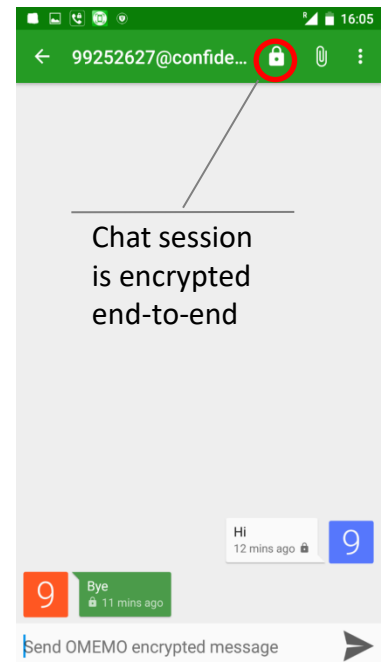



IMEI-Changer *app*

1 Click - Change and restore device IMEI number to gain network anonymity (SIM IMSI should be replaced as well)

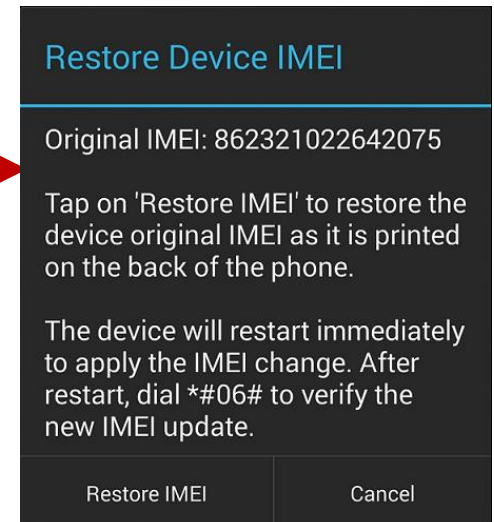
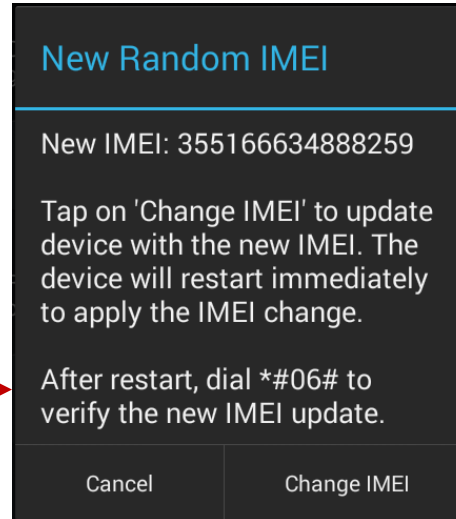
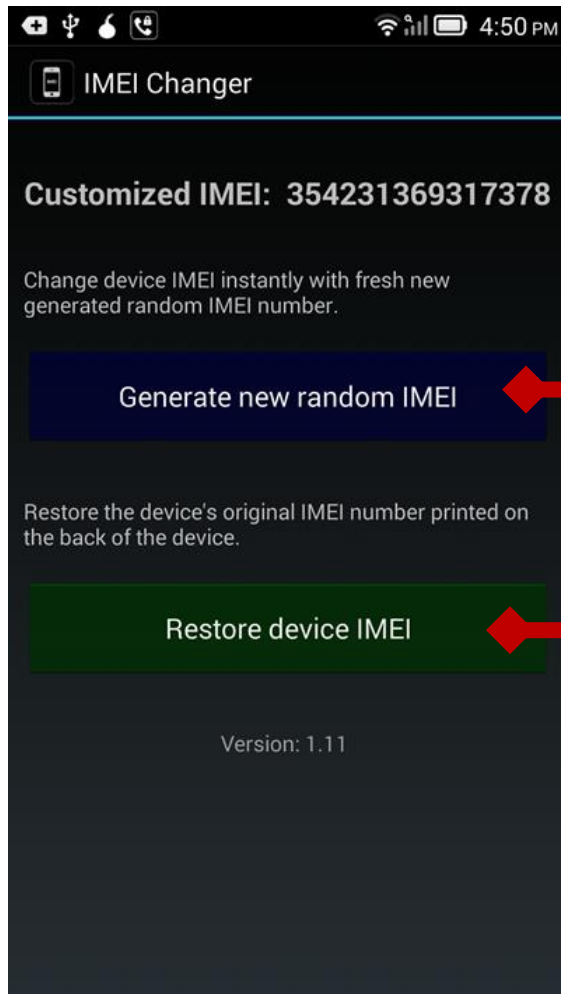



USB-Control *app*

Protect device from USB spyware injection

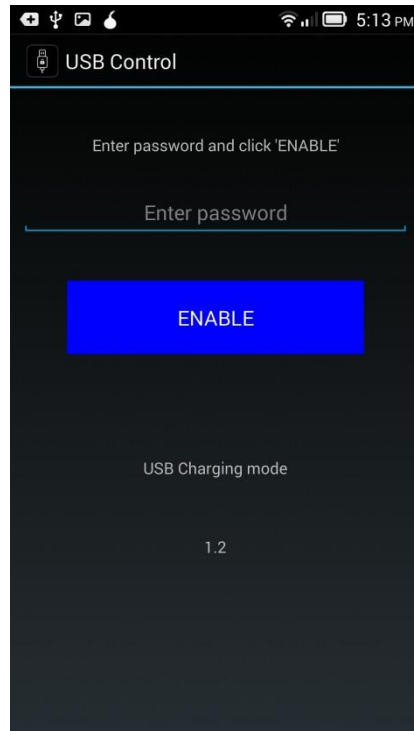

Pop up once USB-PC cable connected

Enable a USB-PC file access only with password verification

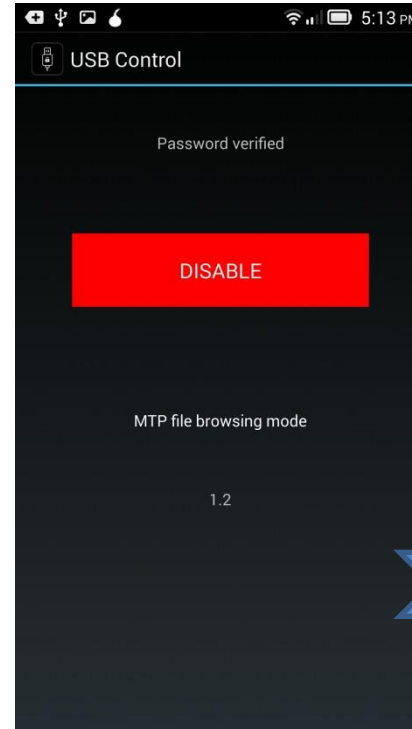

Disappear once USB-PC cable disconnected

Disable USB-PC file access

Confidential-MOBILE

Secure Mobile Phone

